



Sika® CarboStress®

INNOVATIVE STRENGTHENING OF STRUCTURES

- Reinforcement of bridges and buildings.
- Fast and easy applications.
- Low space requirements.
- Factory controlled quality.

Sika® CarboStress®

POSTTENSIONED CFRP-PLATES FOR STRUCTURAL STRENGTHENING

APPLICATION

- Bridge strengthening
- Strengthening of industrial and highrise buildings
- Earthquake strengthening
- Silo and Watertank strengthening

LITERATURE

- Technical Documentation

BENEFITS

All of the benefits of conventional FRP

- Light weight
- Easy to install
- Noncorrosive
- Less labor than conventional steel solutions

Added benefits of Sika StressHead FRP

- Active external post-tensioning (for structural safety and serviceability)
- Concentrated transfer of force at plate ends
- Outstanding fatigue behaviour
- High movement range – no tension loss
- Can be applied under operational conditions
- Factory controlled quality

SYSTEM

Sika Stresshead is a carbon fiber reinforced plastic (CFRP) based posttensioning system for earthquake strengthening, bridge and building reinforcement. The active external prestressing allows an excellent usage of the material properties and provides with the concentrated anchors clear static conditions. Concrete, masonry, steel and wood structures can be strengthened.

Several project-specific anchoring solutions, as well as the simple handling, enable a variety of applications. In advantage of classic bonded CFRP, the Sika StressHead system is also suitable for deformation restrictions.

One system consists of an S626 CFRP-plate with two fix mounted heads for anchoring and can be posttensioned with up to 220kN per plate. The application is carried out bonded or unbonded. It is easy to handle and can be applied under operational conditions.

STRESSHEAD LTD

Sika StressHead already has 20 years of applied experience with approximately 100 projects worldwide. Additionally, long-term measurements have been carried out for 10 years in the StressHead Ltd laboratory.



Bridge strengthening



Strengthening of industrial and highrise buildings

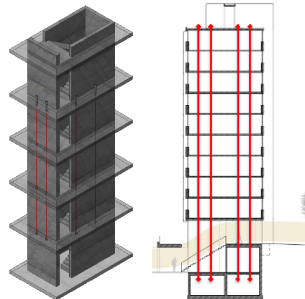

Earthquake strengthening



Silos and Watertanks

FOR MORE INFORMATION:

Contact StressHead: stresshead@stresshead.ch
www.stresshead.ch/en

StressHead Ltd
Leumattstr. 33
CH-6006 Lucerne
Phone: +41 41 210 40 30



BUILDING TRUST

